

# **Bruciatori policombustibile gasolio/gas**

## **Dual fuel Gas-Oil/Gas burners**

### **Brûleurs mixtes fioul/gaz**

#### **Mehrstoffbrenner Heizöl/Gas**

##### **Quemadores policombustible gasóleo / gas**

Funzionamento bistadio progressivo o modulante lato gas / bistadio lato gasolio  
Oil progressive two-stage or modulating operation / Gas two-stage operation  
Fonctionnement fioul à deux allures progressives ou modulant / Fonctionnement gaz à deux allures  
Zweistufiger gleitender oder modulierender Betrieb für Öl / Zweistufig für Gas  
Funcionamiento a dos llamas progresivas o modulante lado gas / a dos llamas lado gasóleo

**OBSOLETE DOCUMENT**

**End validity date 04/2009**

**Refer to document code 2918461**

COD.

**3488100**

MOD.

**RLS 190/M MZ**

TYP.

**784 T**

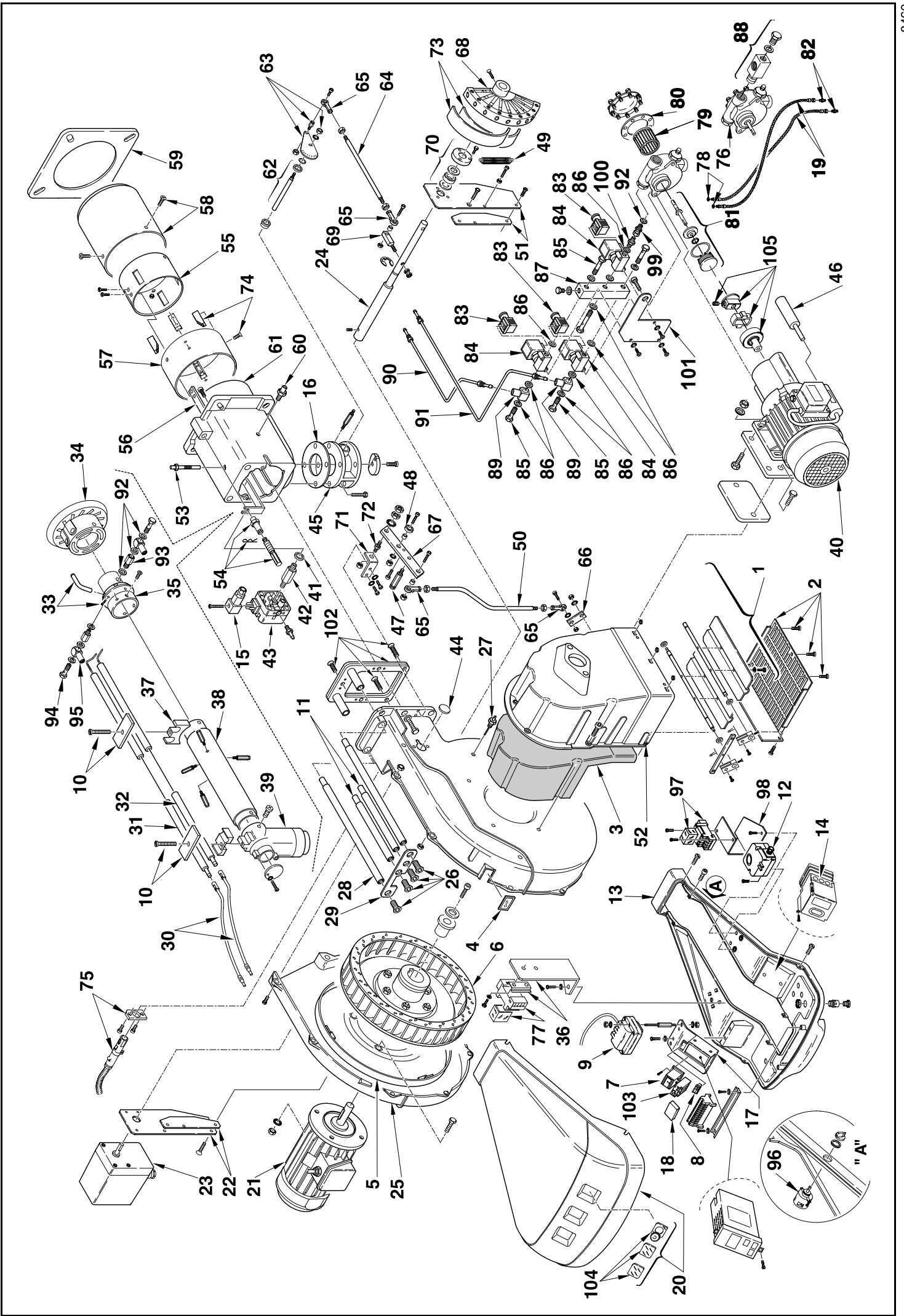

| N. | COD.    | DESCRIZIONE            | DESCRIPTION         | DESCRIPTION              | BESCHREIBUNG             | DENOMINACION              | MATRICOLA BRUCIATORE<br>BURNER SERIAL NUMBER<br>MATRICULE BRULEUR<br>BRENNER KENN-NUMMER<br>MATRICULA QUEMADORES | * |
|----|---------|------------------------|---------------------|--------------------------|--------------------------|---------------------------|--|---|
| 1  | 3012583 | GRUPPO SERRANDA        | AIR DAMPER ASSEMBLY | GROUPE VOLET AIR         | LUFTKLAPPE               | CONJUNTO REGISTRO AIRE    | ≤ 02356xxxxxx  |   |
| 1  | 3013684 | GRUPPO SERRANDA        | AIR DAMPER ASSEMBLY | GROUPE VOLET AIR         | LUFTKLAPPE               | CONJUNTO REGISTRO AIRE    | ≥ 02366xxxxxx  |   |
| 2  | 3003086 | PROTEZIONE             | GRID                | PROTECTION               | SCHUTZGITTER             | PROTECION                 | ≤ 02356xxxxxx  |   |
| 2  | 3013683 | PROTEZIONE             | GRID                | PROTECTION               | SCHUTZGITTER             | PROTECION                 | ≥ 02366xxxxxx  |   |
| 3  | 3012553 | FONOASSORBENTE         | SOUND DAMPING       | INSONORISANT             | GERÄUSCHDÄMMUNG          | AISLAMIENTO ACÚSTICO      | ≤ 02356xxxxxx  | C |
| 3  | 3013682 | FONOASSORBENTE         | SOUND DAMPING       | INSONORISANT             | GERÄUSCHDÄMMUNG          | AISLAMIENTO ACÚSTICO      | ≥ 02366xxxxxx  | C |
| 4  | 3003763 | VISORE                 | INSPECTION WINDOW   | VISEUR                   | SICHTFENSTER             | VISOR                     |  |   |
| 5  | 3012573 | ANELLO                 | PISTON SEAL         | JOINT TORIQUE            | LIPPENDICHTUNG           | RACORD                    |  | B |
| 6  | 3012555 | GIRANTE                | FAN                 | TURBINE                  | GEBLÄSERAD               | TURBINA                   |  | C |
| 7  | 3003637 | CONTATTORE             | CONTACTOR           | CONTACTEUR               | SCHÜTZ                   | CONTACTOR                 |  | C |
| 8  | 3012080 | INTERRUTTORE           | SWITCH              | INTERRUPTEUR             | SCHALTER                 | INTERRUPTOR               |  | C |
| 9  | 3003785 | TRASFORMATORE          | TRANSFORMER         | TRANSFORMATEUR           | ZÜNDTRANSFORMATOR        | TRANSFORMADOR             |  | B |
| 10 | 3012626 | PIASTRINA              | PLATE               | PLAQUETTE ETRIER         | PLATTE                   | PLATTE                    |  |   |
| 11 | 3012627 | PROLUNGA PERNO         | BAR EXTENSION       | RALLONGE DE GLISSIERE    | VERLÄNGERUNG             | PROLUNGACIÓN PERNO        | ≤ 02356xxxxxx  |   |
| 11 | 3013686 | PROLUNGA PERNO         | BAR EXTENSION       | RALLONGE DE GLISSIERE    | VERLÄNGERUNG             | PROLUNGACIÓN PERNO        | ≥ 02366xxxxxx  |   |
| 12 | 3007444 | PRESSOSTATO ARIA       | AIR PRESSURE SWITCH | PRESSOSTAT AIR           | LUFTDRUCKWÄCHTER         | PRESÓSTATO AIRE           |  | A |
| 13 | 3013171 | MENSOLA                | BASE PLATE          | PLAQUE DE SUPPORT        | GRUNDPLATTE              | REPISA                    |  |   |
| 14 | 3006090 | APPARECCHIATURA        | CONTROL BOX         | BOITE DE CONTROLE        | STEUERGERÄT              | CAJA CONTROL              |  | B |
| 15 | 3012347 | PRESA                  | SOCKET              | PRISE                    | STECKBUCHSE              | CONECTOR                  |  | C |
| 16 | 3005482 | GUARNIZIONE            | SEAL                | RONDELLE                 | FLANSCHDICHTUNG          | JUNTA                     |  | B |
| 17 | 3012343 | SUPPORTO               | SUPPORT             | SUPPORT                  | HALTER                   | SOPORTE                   |  |   |
| 18 | 3012155 | FILTRO ANTIDISTURBO    | DEGLITCHER          | FILTRE                   | ENTSTÖRER                | FILTRO ANTI-INTERFERENCIA |  | C |
| 19 | 3006182 | TUBO FLESSIBILE        | FLEXIBLE OIL LINE   | FLEXIBLE                 | SCHLAUCH                 | TUBO FLEXIBLE             |  |   |
| 20 | 3013119 | COFANO                 | COVER               | COFFRET                  | VERKLEIDUNG              | ENVOLVENTE                |  |   |
| 21 | 3012557 | MOTORE                 | MOTOR               | MOTEUR                   | MOTOR                    | MOTOR                     |  | C |
| 22 | 3012585 | PIASTRA                | ANCHOR PLATE        | PLATINE DE BLOCAGE       | ARRETIERPLATTE           | PLACA                     |  |   |
| 23 | 3012345 | SERVOMOTORE            | SERVOMOTOR          | SERVOMOTEUR              | STELLMOTOR               | SERVOMOTOR                |  | B |
| 24 | 3012349 | ALBERO                 | SHAFT               | ARBRE                    | WELLE                    | ARBORILLO                 |  |   |
| 25 | 3012587 | GUSCIO                 | HALF-SHELL          | COUVERCLE                | HAUBE                    | CÁSCARA                   |  |   |
| 26 | 3003481 | VITE                   | SCREW               | VIS                      | SCHRAUBE                 | TORNILLO                  | ≤ 02356xxxxxx  |   |
| 26 | 3013681 | VITE                   | SCREW               | VIS                      | SCHRAUBE                 | TORNILLO                  | ≥ 02366xxxxxx  |   |
| 27 | 3003891 | RACCORDO               | CONNECTOR           | MAMELON                  | NIPPEL                   | RACORD                    |  | C |
| 28 | 3012628 | PERNO                  | BAR                 | GLISSIERE                | BOLZEN                   | PERNO                     | ≤ 02356xxxxxx  | C |
| 29 | 3012629 | STAFFA                 | BRACKET             | SUPPORT                  | KONSOLE                  | SOPORTE                   | ≤ 02356xxxxxx  |   |
| 30 | 3003795 | COLLEGAMENTO ELETTRODO | H.T. LEAD           | CONNEXION POUR ELECTRODE | VERBINDUNG FÜR ELEKTRODE | CABLE CONEXIÓ             |  | A |
| 31 | 3013172 | ELETTRODO              | ELECTRODE           | ELECTRODE PORCELAINE     | ELEKTRODE                | ELECTRODO                 |  | A |
| 32 | 3013174 | ELETTRODO              | ELECTRODE           | ELECTRODE PORCELAINE     | ELEKTRODE                | ELECTRODO                 |  | A |
| 33 | 3013422 | TUBETTO                | TUBE                | TUYAU                    | RÖHRCHEN                 | TUBO                      |  |   |
| 34 | 3013420 | TAZZA                  | AIR DIFFUSER        | DIFFUSEUR D'AIR          | FLAMMKOPFBECHER          | DIFUSOR DEL AIRE          |  | A |
| 35 | 3013177 | DISTRIBUTORE           | GAS HEAD            | DISTRIBUTEUR             | GASVERTEILER             | DISTRIBUIDOR              |  |   |
| 36 | 3013189 | SUPPORTO               | SUPPORT             | HALTER                   | SOPORTE                  | SOPORTE                   |  |   |
| 37 | 3013179 | SUPPORTO               | SUPPORT             | SUPPORT                  | HALTER                   | SOPORTE                   |  |   |
| 38 | 3013418 | TUBO ESTERNO           | EXTERIOR TUBE       | TUYAU EXTERIEUR          | AUSSERER ROHR            | TUBO EXTERNO              |  |   |
| 39 | 3012637 | GOMITO                 | ELBOW               | COUDE                    | SCHLITTEN                | CODO                      |  |   |
| 40 | 3013180 | MOTORE                 | MOTOR               | MOTEUR                   | MOTOR                    | MOTOR                     | ≤ 0243699999   | C |
| 40 | 3013829 | MOTORE                 | MOTOR               | MOTEUR                   | MOTOR                    | MOTOR                     | ≥ 0244600000   | C |
| 41 | 3007088 | GUARNIZIONE            | SEAL                | RONDELLE                 | METALLDICHTUNG           | JUNTA                     |  | C |
| 42 | 3006615 | RACCORDO               | CONNECTOR           | MAMELON                  | NIPPEL                   | RACORD                    |  | C |
| 43 | 3003660 | PRESSOSTATO GAS        | GAS PRESSURE SWITCH | PRESSOSTAT GAZ           | GAS DRUCKWÄCHTER         | PRESÓSTATO GAS            |  | B |

| N. | COD.    | DESCRIZIONE         | DESCRIPTION       | DESCRIPTION          | BESCHREIBUNG      | DENOMINACION          | MATRICOLA BRUCIATORE<br>BURNER SERIAL NUMBER<br>MATRICULE BRULEUR<br>BRENNER KENN-NUMMER<br>MATRICULA QUEMADORES | * |
|----|---------|---------------------|-------------------|----------------------|-------------------|-----------------------|--|---|
| 44 | 3003996 | TAPPO               | PLUG              | BOUCHON A VIS        | SCHRAUBSTÖPSEL    | TAPÓN                 |  |   |
| 45 | 3006096 | REGOLATORE GAS      | GAS REGULATOR     | REGULATEUR GAZ       | GAS REGLER        | REGULACION GAS        |  | C |
| 46 | 3013182 | CONDENSATORE        | CONDENSER         | CONDENSATEUR         | KONDENSATOR       | CONDENSADOR           | ≤ 02436999999  | B |
| 46 | 3013875 | CONDENSATORE        | CONDENSER         | CONDENSATEUR         | KONDENSATOR       | CONDENSADOR           | ≥ 02446000000  | B |
| 47 | 3012352 | PERNO               | BAR               | GLISSIERE            | BOLZEN            | PERNO                 |  | C |
| 48 | 3003841 | CUSCINETTO          | BEARING           | ROULEMENT            | LAGER             | COJINETE              |  |   |
| 49 | 3012356 | MOLLA               | SPRING            | RESSORT              | FEDER             | MUELLE                |  | A |
| 50 | 3012646 | TIRANTE             | TIE ROD           | TIRANT               | GESTÄNGE          | TIRANTE               |  | C |
| 51 | 3012594 | PIASTRA             | ANCHOR PLATE      | PLATINE DE BLOCAGE   | ARRETIERPLATTE    | PLACA                 |  |   |
| 52 | 3012828 | BOCCA D'ASPIRAZIONE | AIR INTAKE        | BOITIER D'ASPIRATION | ANSAUGÖFFNUNG     | BOCA DE ASPIRACIÓN    | ≤ 02356xxxxxx  |   |
| 53 | 3012049 | VITE                | SCREW             | VIS                  | SCHRAUBE          | TORNILLO              |  |   |
| 54 | 3012639 | GRUPPO REGOLATORE   | CONTROL DEVICE    | GROUPE OBTURATION    | DRUCKREGULIERUNG  | GRUPO REGULACION      |  | C |
| 55 | 3012560 | OTTURATORE          | SHUTTER           | OBTURATEUR           | SCHIEBER          | OBTURADOR             |  | C |
| 56 | 3013419 | STAFFA              | BRACKET           | SUPPORT              | KONSOLE           | SOPORTE               |  |   |
| 57 | 3013421 | CILINDRO            | SLEEVE            | CYLINDRE             | ZYLINDER          | CILINDRO              |  | C |
| 58 | 3012561 | IMBUTO FIAMMA       | END CONE          | EMBOUT GUEULARD      | FLAMMENROHR       | TUBO EXTREMO          |  | B |
| 59 | 3012562 | SCHERMO             | FLANGE GASKET     | ECRAN THERMIQUE      | FLASCHDICHTUNG    | JUNTA AISLANTE        |  | A |
| 60 | 3003322 | RACCORDO            | CONNECTOR         | MAMELON              | NIPPEL            | RACORD                |  | C |
| 61 | 3013184 | MANICOTTO           | MANIFOLD          | MANCHON              | GASANSCHLUSS      | COLARIN               | ≤ 02356xxxxxx  |   |
| 62 | 3006132 | ALBERO E ANELLO     | SHAFT AND RING    | ARBRE ET ANNEAU      | WELLE UND RING    | ÁRBOLILLO Y ANILLO    |  | C |
| 63 | 3012644 | QUADRANTE           | GRADUATE SECTOR   | SECTEUR GRADUE       | SKALENSEGMENT     | SECTOR GRADUADO       |  | C |
| 64 | 3012600 | TIRANTE             | TIE ROD           | TIRANT               | GESTÄNGE          | TIRANTE               | ≤ 02356xxxxxx  | C |
| 64 | 3003543 | TIRANTE             | TIE ROD           | TIRANT               | GESTÄNGE          | TIRANTE               | ≥ 02366xxxxxx  | C |
| 65 | 3006098 | SNODO SFERICO       | PIN JOINT         | CHAPE A ROTULE       | KUGELGELENK       | ARTICOLACION ESFERICA |  | C |
| 66 | 3012601 | LEVA                | LEVER             | LEVIER               | HEBEL             | PALANCA               |  | C |
| 67 | 3012354 | LEVA                | LEVER             | LEVIER               | HEBEL             | PALANCA               |  | C |
| 68 | 3012358 | CAMMA               | CAM               | CAME                 | NOCKEN            | EXCÉNTRICO            |  |   |
| 69 | 3012350 | LEVA                | LEVER             | LEVIER               | HEBEL             | PALANCA               |  | C |
| 70 | 3012357 | CUSCINETTO          | BEARING           | ROULEMENT            | LAGER             | COJINETE              |  |   |
| 71 | 3012602 | SUPPORTO            | SUPPORT           | SUPPORT              | HALTER            | SOPORTE               |  |   |
| 72 | 3012603 | PERNO               | BAR               | GLISSIERE            | BOLZEN            | PERNO                 |  |   |
| 73 | 3006097 | MOLLA               | SPRING            | RESSORT              | FEDER             | MUELLEA               |  | C |
| 74 | 3012647 | BASSETTA            | CENTERING SUPPORT | ELEMENT DE CENTRAGE  | ZENTRIERHALTERUNG | SOPORTE               |  |   |
| 75 | 3003396 | FOTOCCELLULAU.V.    | DETECTOR          | PHOTOCELLULE U.V.    | U.V. PHOTOZELLE   | FOTORESISTENCIA       |  | A |
| 76 | 3006369 | POMPA               | PUMP              | POMPE                | PUMPE             | BOMBA                 |  | C |
| 77 | 3013190 | RELE TERMICO        | OVERLOAD          | RELAIS THERMIQUE     | ÜBERSTROMAUSLÖSER | RELÉ TÉRMICO          |  | C |
| 78 | 3007164 | GUARNIZIONE         | SEAL              | RONDELLE             | METALLDICHTUNG    | JUNTA                 |  | B |
| 79 | 3006787 | FILTRO              | FILTER            | FILTRE               | FILTER            | FILTRO                |  | A |
| 80 | 3006292 | GUARNIZIONE         | SEAL              | RONDELLE             | METALLDICHTUNG    | JUNTA                 |  | B |
| 81 | 3000805 | ORGANO DI TENUTA    | PUMP SEAL         | ORGANE D'ETANCHEITE  | WELLENDICHTUNG    | CONJUNTO ESTANQUIDAD  |  | B |
| 82 | 3006181 | RACCORDO            | CONNECTOR         | MAMELON              | NIPPEL            | RACORD                |  | C |
| 83 | 3006953 | PRESA               | HOLDER            | PRISE CELLULE        | SOCKEL            | CONECTOR              |  | B |
| 84 | 3012002 | VALVOLA             | NEEDLEVALVE       | VANNE POINTEAU       | NADELVENTIL       | VÁLVLULA              |  |   |
| 85 | 3003592 | PERNO               | BAR               | GLISSIERE            | BOLZEN            | PERNO                 |  | C |
| 86 | 3007077 | GUARNIZIONE         | SEAL              | RONDELLE             | METALLDICHTUNG    | JUNTA                 |  | B |
| 87 | 3012569 | COLLETTORE          | MANIFOLD          | COLLECTEUR           | SAMMLER           | COLECTOR              |  | C |
| 88 | 3003681 | RACCORDO            | CONNECTOR         | MAMELON              | NIPPEL            | RACORD                |  | C |
| 89 | 3006722 | RACCORDO            | CONNECTOR         | MAMELON              | NIPPEL            | RACORD                |  | C |
| 90 | 3013423 | TUBO                | TUBE              | TUYAUTERIE           | DRUCKROHR         | TUBO                  | ≤ 02126999999  |   |

| N.  | COD.    | DESCRIZIONE       | DESCRIPTION           | DESCRIPTION      | BESCHREIBUNG             | DENOMINACION      | MATRICOLA BRUCIATORE<br>BURNER SERIAL NUMBER<br>MATRICULE BRULEUR<br>BRENNER KENN-NUMMER<br>MATRICULA QUEMADORES | * |
|-----|---------|-------------------|-----------------------|------------------|--------------------------|-------------------|--|---|
| 90  | 3013672 | TUBO              | TUBE                  | TUYAUTERIE       | DRUCKROHR                | TUBO              | ≥ 02136000001;<br>≤ 02356xxxxxx  |   |
| 90  | 3013709 | TUBO              | TUBE                  | TUYAUTERIE       | DRUCKROHR                | TUBO              | ≥ 02366xxxxxx  |   |
| 91  | 3013424 | TUBO              | TUBE                  | TUYAUTERIE       | DRUCKROHR                | TUBO              | ≤ 02126999999  |   |
| 91  | 3013673 | TUBO              | TUBE                  | TUYAUTERIE       | DRUCKROHR                | TUBO              | ≥ 02136000001;<br>≤ 02356xxxxxx  |   |
| 91  | 3013710 | TUBO              | TUBE                  | TUYAUTERIE       | DRUCKROHR                | TUBO              | ≥ 02366xxxxxx  |   |
| 92  | 3007079 | GUARNIZIONE       | SEAL                  | RONDELLE         | METALLDICHTUNG           | JUNTA             |  | B |
| 93  | 3013417 | RACCORDO          | CONNECTOR             | MAMELON          | NIPPEL                   | RACORD            |  | C |
| 94  | 3003006 | PERNO             | BAR                   | GLISSIERE        | BOLZEN                   | PERNO             |  | C |
| 95  | 3006784 | RACCORDO          | CONNECTOR             | MAMELON          | NIPPEL                   | RACORD            |  | C |
| 96  | 3012310 | COMMUTATORE       | SELECTOR SWITCH       | COMMUTATOR       | WAHLSCHALTER             | CONMUTADOR        |  |   |
| 97  | 3012292 | RELE' TERMICO     | OVERLOAD              | RELAIS THERMIQUE | ÜBERSTROMAUSLÖSER        | RELÉ TÉRMICO      |  | C |
| 98  | 3012423 | SUPPORTO          | BRACKET               | SUPPORT          | HALTERUNG                | SOPORTE           |  |   |
| 99  | 3013462 | RACCORDO GIREVOLE | SWIVEL FITTING        | TOURNANT         | DREHANSCHLUSS            | EMPALME GIRATORIO | ≥ 02136000001  | C |
| 100 | 3013185 | RACCORDO          | CONNECTOR             | MAMELON          | NIPPEL                   | RACORD            | ≥ 02136000001  | C |
| 101 | 3013671 | STAFFA            | BRACKET               | SUPPORT          | KONSOLE                  | SOPORTE           | ≥ 02136000001  |   |
| 102 | 3013685 | GRUPPO PIASTRE    | PLATES ASSEMBLY       | GROUPE           | PLATINES                 | PLATTENGRUPPE     | ≥ 02366xxxxxx  |   |
| 103 | 3013676 | RELE' TERMICO     | OVERLOAD              | RELAIS THERMIQUE | ÜBERSTROMAUSLÖSER        | RELÉ TÉRMICO      |  | C |
| 104 | 3013678 | MEMBRANA+VETRINO  | MEMBRANE+VIEWING PORT | MEMBRANE+REGARD  | MEMBRAN+VERSCHLUßSTOPFEN | MEMBRANA+MIRILLA  |  |   |
| 105 | 3013828 | GIUNTO            | JOINT                 | ACCOUPLMENT      | PUMPENKUPPLUNG           | ACOPLAMIENTO      |  | A |

8460

\*

**RICAMBI CONSIGLIATI - ADVISED SPARE PARTS - RECHANGE CONSEIL - EMPFOHLENE ERSATZTEILE - RECAMBIOS ACONSEJADOS**

A = Ricambi per dotazione minima - Spare parts for minimum fittings - Pièces détachées pour équipement minimum - Ersatzteile für minimale Ausstattung - Recambios para equipamiento mínimo.

A+B = Ricambi per dotazione base di sicurezza - Spare parts for basic safety fittings - Pièces détachées pour équipement standard de sécurité - Ersatzteile für Sicherheitsgrundausrüstung - Recambios para equipamiento básico de seguridad.

A+B+C = Ricambi per dotazione estesa di sicurezza - Spare parts for extended safety fittings - Pièces détachées pour équipement complet de sécurité - Ersatzteile für erweiterte Sicherheitsausstattung - Recambios para equipamiento general de seguridad.



RIELLO S.p.A.  
I-37045 Legnago (VR)  
Tel.: +39.0442.630111  
[http:// www.riello.it](http://www.riello.it)