

Ecoflam



BLU



Ecoflam



GAS BURNERS

燃气燃烧器



Ecoflam was founded in 1973 in Castelfranco Veneto, near Venice in the North East of Italy. For more than thirty years Ecoflam has continued to develop all its products with constant dedication and determination addressing Technological Research, Ecology, Energy Saving, and Safety.

Ecoflam today offers a full range of blown air pressure jet burners designed and tested in our "GREEN" modern laboratories. All products conform to CE standards and are manufactured in accordance with ISO 9001 and VISION 2000 certification.

Ecoflam burners guarantee high efficiency and reliable operation with significant energy savings. All models feature extreme ease of installation maintenance and flexible boiler - burner matching.



意高（意大利）燃烧设备有限公司在1973年位于意大利北部近威尼斯的Castelfranco Veneto成立。拥有超过30年经验的意高公司，仍不断致力发展各类的产品，并且决心专注技术研究、生态保护、节约能源及安全性等。

意高公司今天能提供各类型的压力吹风式燃烧器。所有燃烧器都在“GREEN”绿色环保实验中心设计及测试，产品全通过CE标准及按照ISO9001及VISION 2000证书标准生产。

意高公司燃烧器保证有高效能，可靠的操作性及高节能特性。所有型号均带有容易安装维修及灵活与锅炉配套使用的特性。

OPERATION / 操作模式

P	On-Off Soft Start	软性起动单段火
...P AB	HI-LOW with servomotor	伺服马达控制 - 两段火
...PR	Progressive	渐进式
...MD	Modulating	比例调节

MAIN FEATURES / 主要特点

- Aluminium casing up to Blu P 4000.1 and steel casing from P 5000.1 with electrical panel integrated on the burner.
- New high efficiency fan ventilator designed to give flame stability and easy matching.
- Adjustable combustion head for fine tuning / matching with different shapes of combustion chamber.
- Low NO_x versions available from BLU 500.1 to 1400.1 (Class 3 < 80mg/kWh, as per EN 676).
- Hi - Low version with easy and fast butterfly ratio system available from Blu P 500 to Blu 2000.1.
- Progressive version with electrical servomotor and adjustable mechanical cam that allows gas fine tuning.
- Modulating version with PID system controller with digital set point display and real time value (PID RWF 40 or LMV 51/52 optional).
- Firing head with automatic adjustable system for primary air that changes according to output required from Blu P 7000.1.
- Easy maintenance of firing head from the burner top cover.
- On request tailored solutions of flame shape.

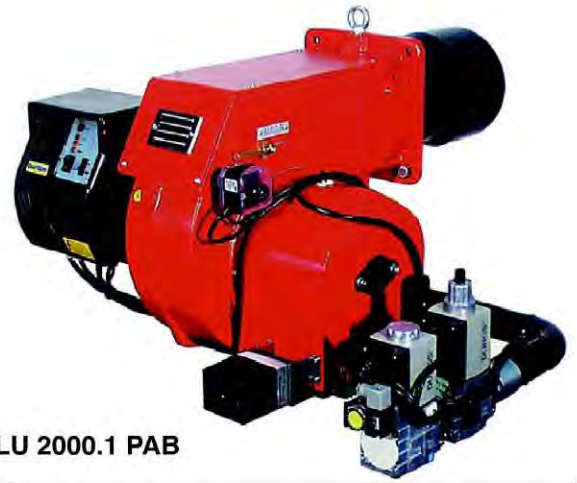

BLU 2000.1 PAB

- 由Blu P 170 至Blu P 4000.1型号采用铝质外壳、由Blu P 5000.1型号采用钢外壳并且配有整合式电控箱。
- 采用特别设计的高效率风机能提供高稳定性火焰及易于配套设备。
- 可调节燃烧头以供调校 / 选配不同形状的炉膛。
- 低氮型号:由Blu P 500 至 Blu P 1400.1可供选购 (Class 3 < 80mg/kWh, 按照 EN 676标准)。
- 两段火型号:由Blu P 500 至 Blu 2000.1采用简易运作的比例蝶阀系统。
- 渐进式型号:采用伺服马达及机械凸轮以供微调使用。
- 比例调节型号:配有数码设定点及实时数值显示的PID调节控制器(PID RWF 40 or LMV 51/52调节器供选配)。
- 由Blu P 7000.1 以上型号, 自动调节燃烧头可按输出功率要求而改变一次风量。
- 拆开燃烧器顶盖即可轻易地维修燃烧头。
- 火焰形状可按要求更改。

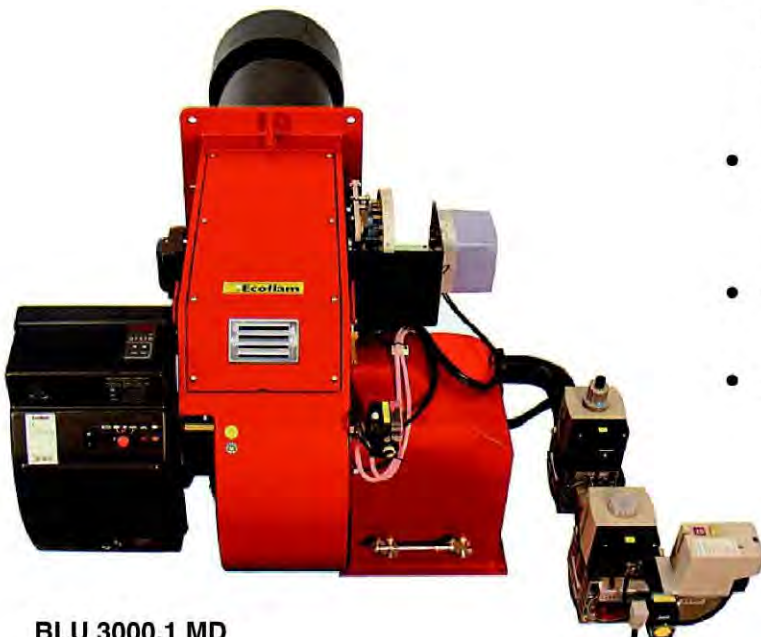

BLU 3000.1 MD

WORKING FIELDS / 工作范围

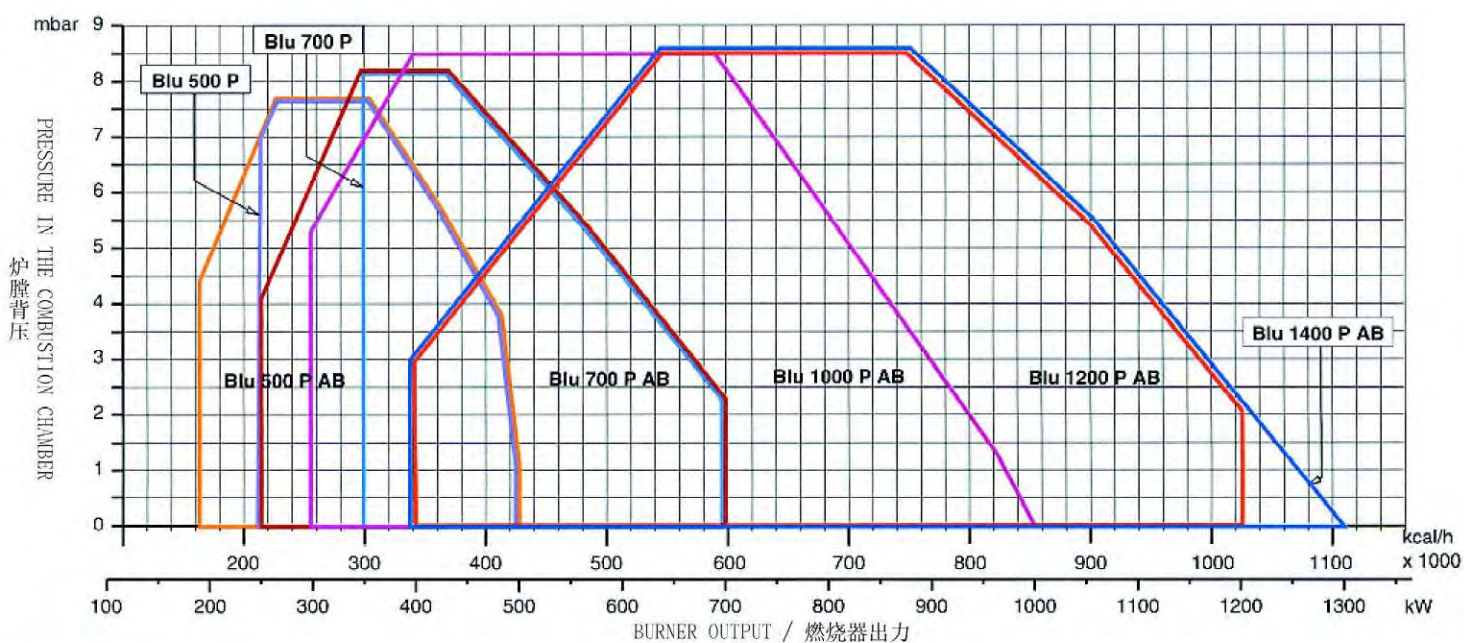
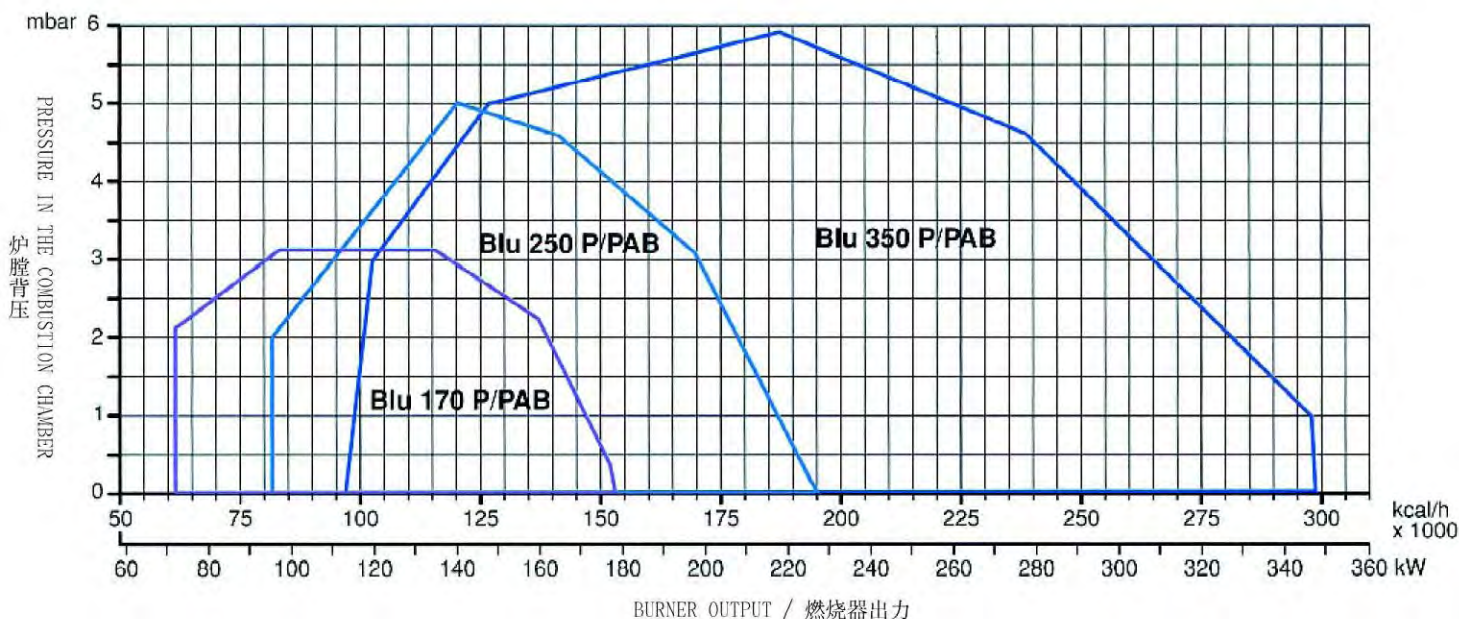

TECHNICAL DATA / 技术数据

MODELS 型号	Output 最大输出 max.		Output 最小输出 min.		Gas pressure 供气压力 gas mbar	Power supply 电源 V	Motor 马达 kW	Operation 操作
	kW	kcal/hx1000	kW	kcal/hx1000				
BLU 170	180	154.8	89	76.54	20÷300	230/400	0.25	P-P AB
BLU 250	230	197.8	95	81.7	20÷300	230/400	0.25	P-P AB
BLU 350	350	301	147	126.42	20÷300	230/400	0.3	P-P AB
BLU 500	500	430	250	215.4	20÷300	230/400	0.55	P
BLU 500	500	430	190	163.4	20÷300	230/400	0.55	P AB
BLU 700	700	602	350	301	20÷300	230/400	0.74	P
BLU 700	700	602	250	215	20÷300	230/400	0.74	P AB
BLU 1000	1,000	860	300	258	20÷300	230/400	1.1	P AB
BLU 1200	1,200	1,032	400	344	20÷300	230/400	2.2	P AB
BLU 1400	1,300	1,118	400	344	20÷300	230/400	2.2	P AB

Fuel: Natural Gas (L.C.V. 8,570 kcal/Nm³), LPG (L.C.V. 22,260 kcal/Nm³) 燃料: 天然气(热值 8,570 kcal/Nm³), 液化气(热值 22,260 kcal/Nm³)

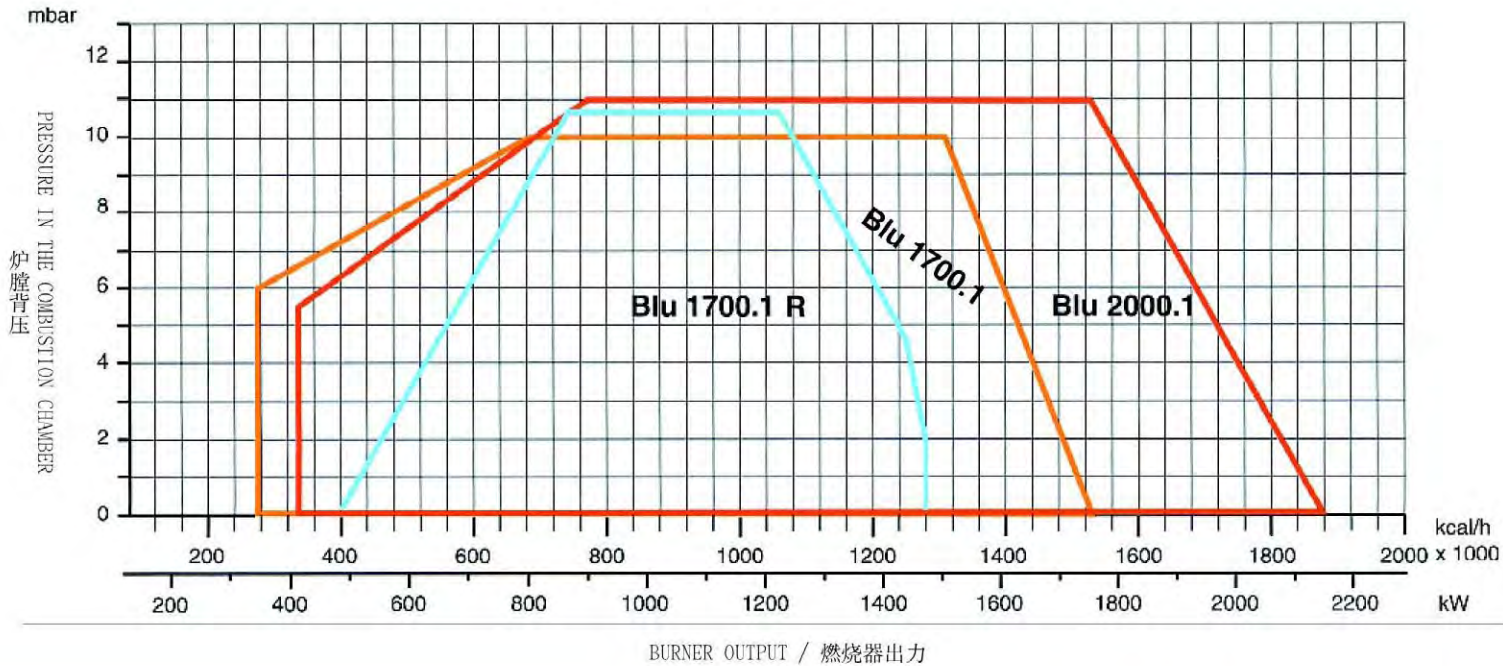
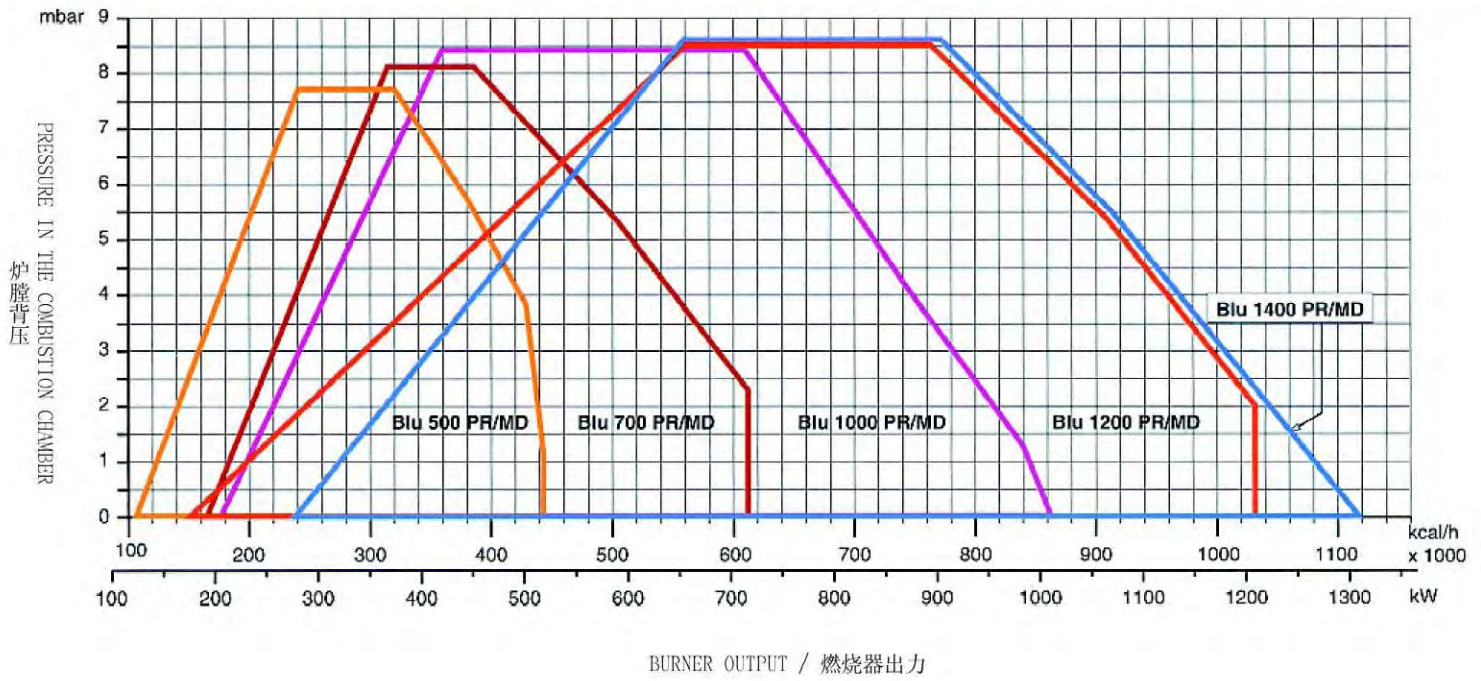

TECHNICAL DATA / 技术数据

MODELS 型号	Output 最大输出 max.		Output 最小输出 min.		Gas pressure 供气压力 gas	Power supply 电源	Motor 马达	Operation 操作
	kW	kcal/hx1000	kW	kcal/hx1000	mbar	V	kW	
BLU 500	500	430	120	103.2	20÷300	230/400	0.55	PR-MD
BLU 700	700	602	190	163.4	20÷300	230/400	0.74	PR-MD
BLU 1000	1,000	860	200	172	20÷300	230/400	1.1	PR-MD
BLU 1200	1,200	1,032	180	154.8	20÷300	230/400	2.2	PR-MD
BLU 1400	1,300	1,118	250	215	20÷300	230/400	2.2	PR-MD
BLU 1700.1 R	1,470	1,264	480	412.8	20÷300	230/400	3	P AB-PR-MD
BLU 1700.1	1,770	1,526	342	295	20÷300	230/400	3	P AB-PR-MD
BLU 2000.1	2,150	1,853.45	414	356.9	20÷300	230/400	4	P AB-PR-MD

Fuel: Natural Gas (L.C.V. 8,570 kcal/Nm³), LPG (L.C.V. 22,260 kcal/Nm³) 燃料: 天然气(热值 8,570 kcal/Nm³), 液化气(热值 22,260 kcal/Nm³)

WORKING FIELDS / 工作范围

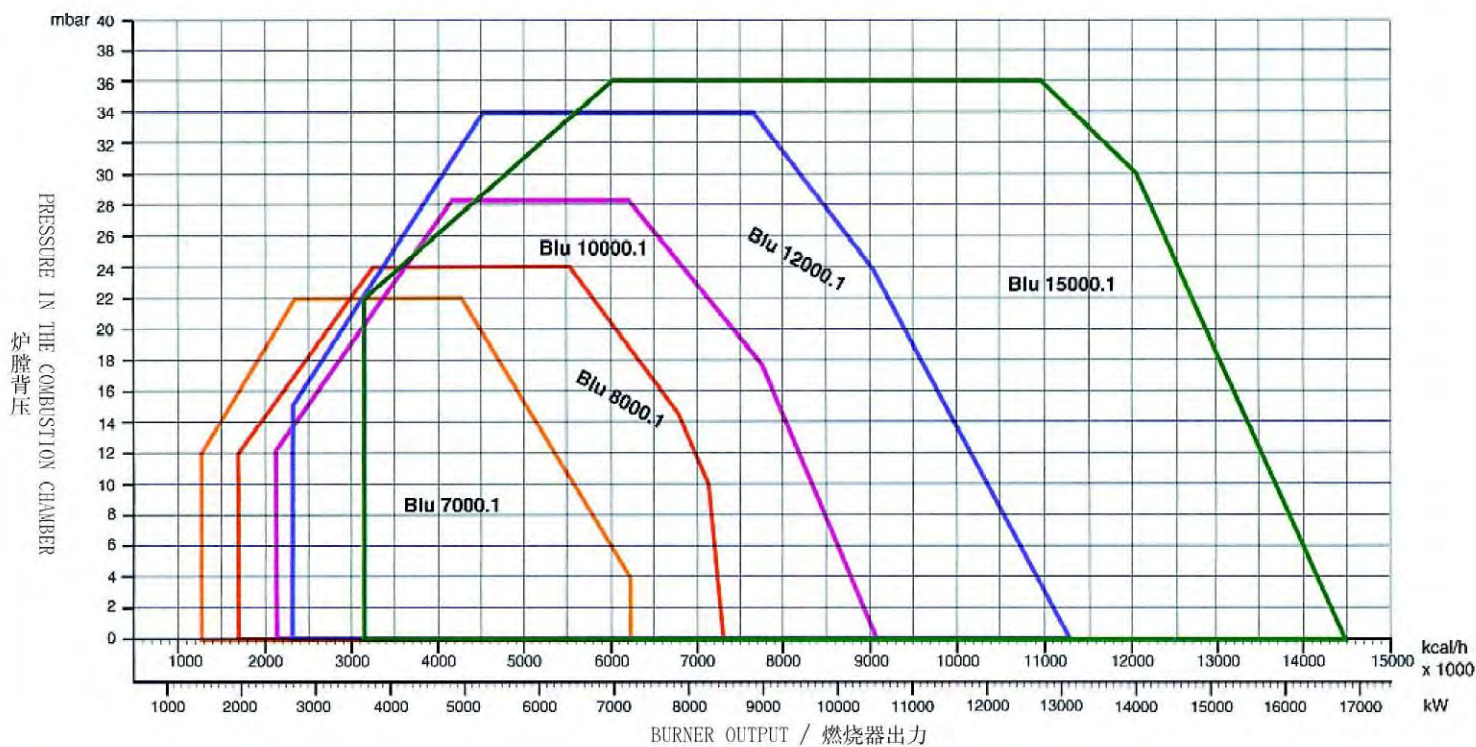
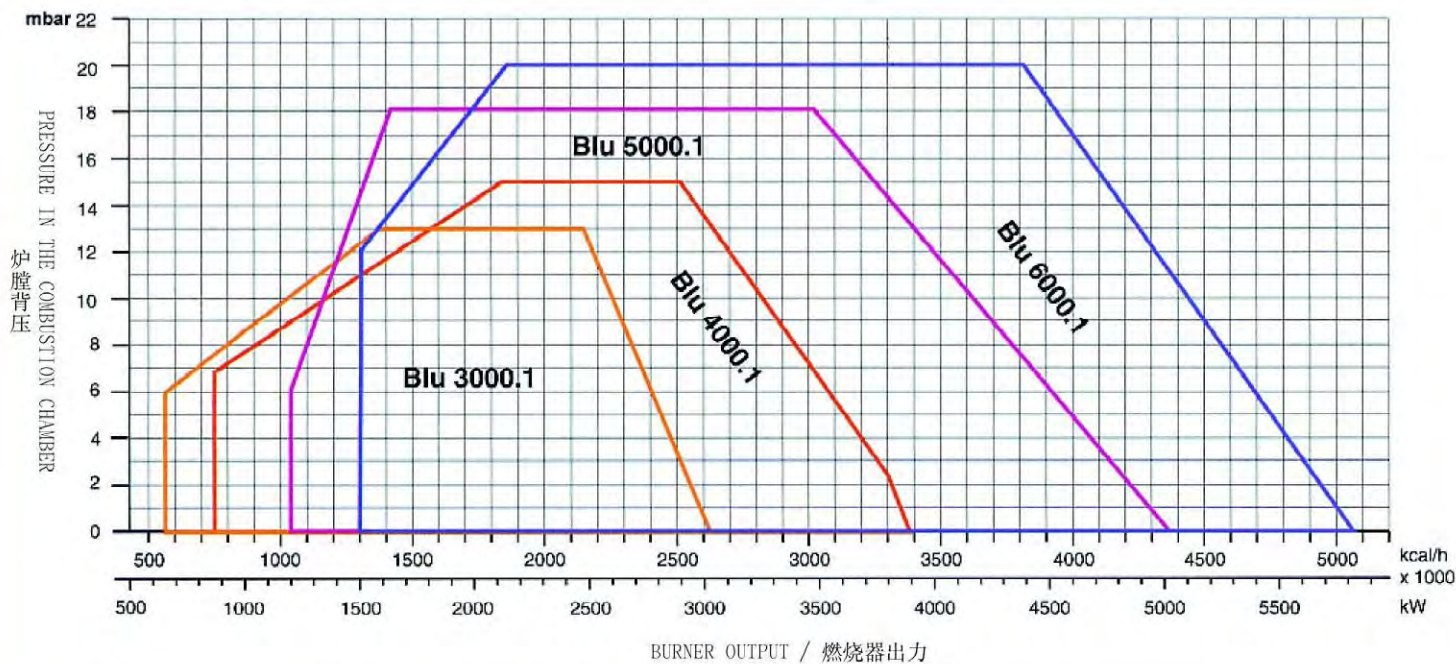

TECHNICAL DATA / 技术数据

MODELS 型号	Output 最大输出 max.		Output 最小输出 min.		Gas pressure 供气压力 gas mbar	Power supply 电源 V	Motor 马达 kW	Operation 操作
	kW	kcal/hx1000	kW	kcal/hx1000				
BLU 3000.1	3,000	2,586	630	543.1	40÷300	230/400	5.5	PR-MD
BLU 4000.1	3,900	3,362	875	754.3	40÷300	230/400	7.5	PR-MD
BLU 5000.1	5,000	4,310	1,200	1,034.5	40÷300	230/400	11	PR-MD
BLU 6000.1	5,800	5,000	1,500	1,290	50÷500	230/400	15	PR-MD
BLU 7000.1	7,250	6,250	1,500	1,290	50÷500	230/400	15	PR-MD
BLU 8000.1	8,500	7,327.5	2,000	1,724	100÷500	230/400	18.5	PR-MD
BLU 10000.1	10,500	9,052	2,500	2,155	100÷500	230/400	22	PR-MD
BLU 12000.1	13,100	11,293.1	2,700	2,327.6	150÷500	230/400	37	PR-MD
BLU 15000.1	16,800	14,448	3,464	2,986	200÷500	230/400	45	PR-MD

Fuel: Natural Gas (L.C.V. 8,570 kcal/Nm³), LPG (L.C.V. 22,260 kcal/Nm³) 燃料: 天然气(热值 8,570 kcal/Nm³), 液化气(热值 22,260 kcal/Nm³)



RWF 40 Regulator
RWF 40 比例调节器



Progressive version with servomotor
and adjustable mechanical cam
渐近式型号:采用伺服马达及机械凸轮

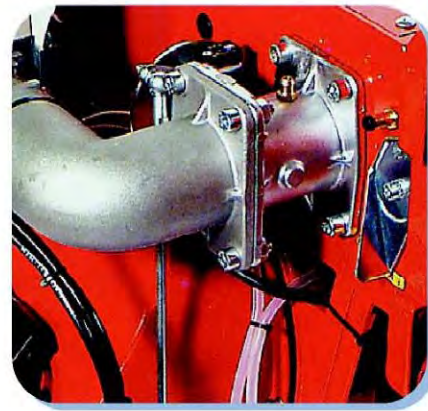

Butterfly valve
蝶阀
Blu 500 ÷ 1400 PAB



LMV51/52 System
LMV51/52 系统



Modulating version with PID
regulation (proportional,
integral and derivative)
digital control board.

比例调节型号配有PID调节
(比例,积分及微分)数码
控制面板



Blu 8000.1 MD



Integrated electric panel
整合式电控箱
Blu 500 ÷ 1400 PAB



Diffuser
稳焰盘
Blu 500 P AB

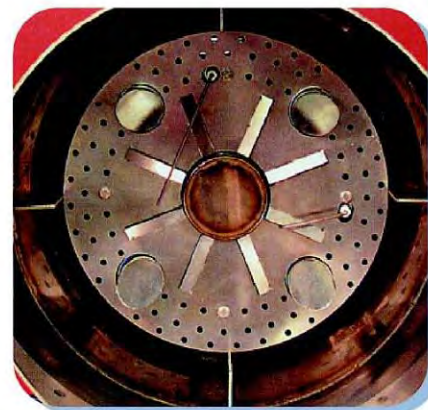

Diffuser
稳焰盘
Blu 8000.1 PR/MD

LOW NOx 低氮型



- The new range of Ecoflam Low NOx gas burners is the direct response to the need to reduce atmospheric pollutants in particular acid rain.
- The new Ecoflam engineered and designed combustion heads enable the burners to surpass the most stringent regulations and standards regarding pollutant emissions, see emission classification table.
- The new range of Low NOx gas burners are built to the highest quality and engineering standards as expected from Ecoflam thus ensuring high efficiency and reliable operation.



- 新系列的Ecoflam"意高"低氮型燃气燃烧器是针对减少大气污染中酸雨形成而设计。
- 新设计的燃烧头确保通过在排放分类表中污染物排放的最严格的条例及标准。
- 新系列的Ecoflam"意高"低氮型燃气燃烧器是按最高质量及工程标准而制造以确保高效率及可靠的运作。

Combustion head
燃烧头
Blu 500 P AB

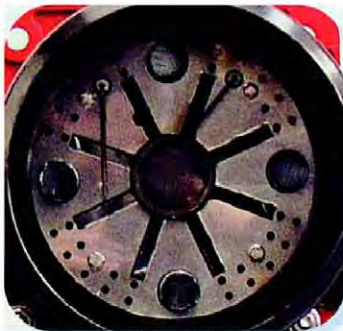

NOISE LEVEL / 噪音标准

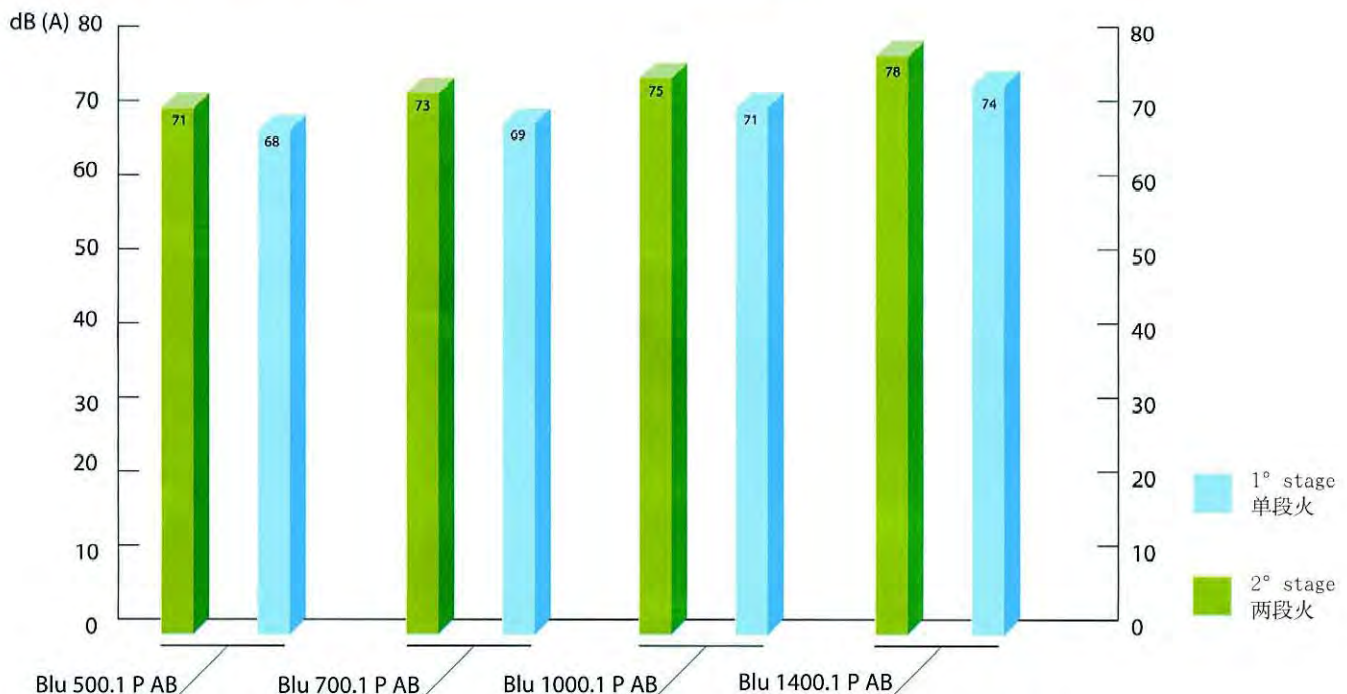

Data registered from the test done with the distance of 1 metre from the burner.
距离燃烧器1米作测试

Class 2-EN 676 ≤ 120 mg/kWh

LRV 92 Svizzera

Class 3-EN 676 ≤ 80 mg/kWh

RAL UZ 80 - 41 Germania

Belgio ≤ 70 mg/kWh

Classi 级别	EN 676
1	170
2	120
3	80

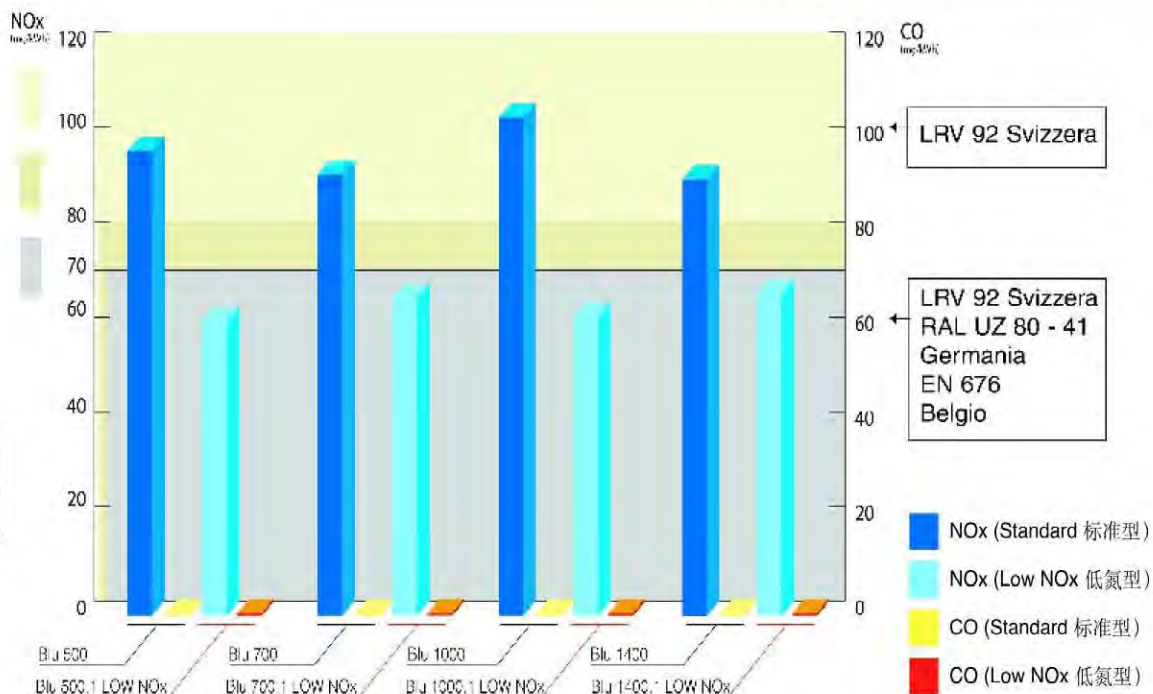

Data from the test done on the boiler as per EN676 at maximum output.
锅炉按照EN676以最大输出功率作测试

WORKING FIELDS / 工作范围

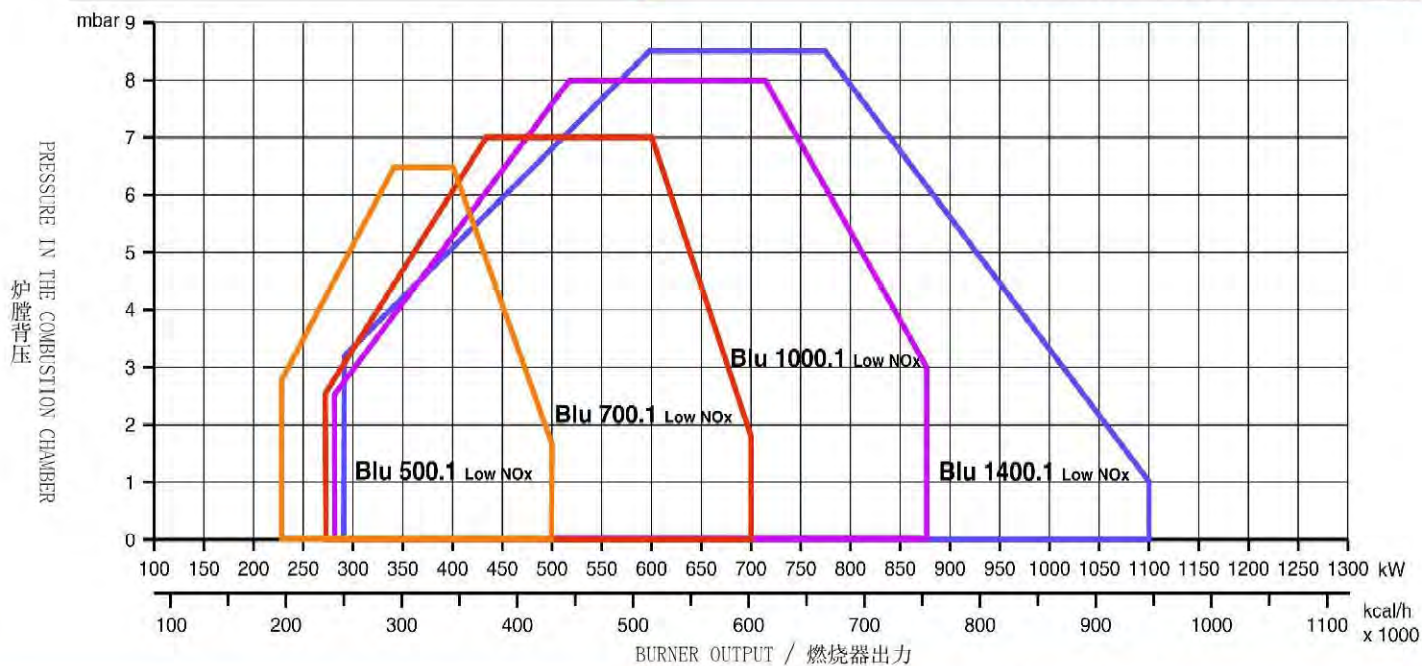

TECHNICAL DATA / 技术数据

MODELS 型号	Output 最大输出 max.		Output 最小输出 min.		Gas pressure 供气压力 gas	Power supply 电源	Motor 马达	Operation 操作
	kW	kcal/hx1000	kW	kcal/hx1000	mbar	V	kW	
BLU 500.1 Low NOx	500	430	230	197.8	20 ÷ 300	230/400	0.55	P AB-PR-MD
BLU 700.1 Low NOx	700	602	270	232.2	20 ÷ 300	230/400	0.74	P AB-PR-MD
BLU 1000.1 Low NOx	875	752.5	280	240.8	20 ÷ 300	230/400	1.1	P AB-PR-MD
BLU 1400.1 Low NOx	1,100	946	290	249.4	20 ÷ 300	230/400	2.2	P AB-PR-MD

Fuel: Natural Gas (L.C.V. 8,570 kcal/Nm³), LPG (L.C.V. 22,260 kcal/Nm³) 燃料: 天然气(热值 8,570 kcal/Nm³), 液化气(热值 22,260 kcal/Nm³)

Dungs SV-SVDLE

To be supplied by the installer

由安装者提供

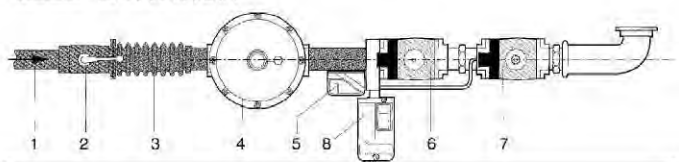

- 1 - Main gas pipe / 主供气管
- 2 - Ball valve / 球阀
- 3 - Antivibration coupling / 膨胀接
- 4 - Gas filter / 过滤器
- 5 - Gas pressure switch / 气压开关
- 6 - Actuator / 电磁阀起动机
- 7 - Actuator / 电磁阀起动机
- 8 - Gas valve / 阀身
- 9 - Leakage control / 检漏装置

- 1 - Main gas pipe / 主供气管
- 2 - Ball valve / 球阀
- 3 - Antivibration coupling / 膨胀接
- 4 - Gas governor / 调压阀
- 5 - Gas pressure switch / 气压开关
- 6 - Safety gas valve / 安全电磁阀
- 7 - Working gas valve / 工作电磁阀
- 8 - Leakage control / 检漏装置

Landis VGD...

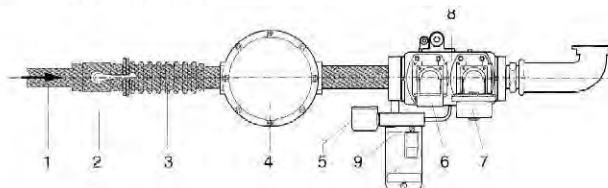

Dungs MB-MBDLE

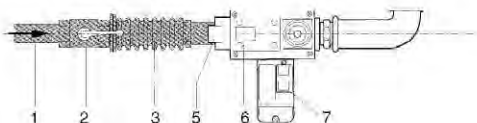

- 1 - Main gas pipe / 主供气管
- 2 - Ball valve / 球阀
- 3 - Antivibration coupling / 膨胀接
- 5 - Gas pressure switch / 气压开关
- 6 - Gas valve / 组合阀
- 7 - Leakage control / 检漏装置

HOW TO CALCULATE THE OVERALL DIMENSION OF BURNER COMPLETE WITH THE MATCHING GAS TRAIN

如何计算燃烧器装上供气管道的整体尺寸?

In order to calculate the overall dimension of the burner complete with gas train, you need to consider value "N" and "V" indicated in the burner leaflet and the dimension, of the matching gas train chosen, according to the inlet gas pressure available in the gas train leaflet.

为了计算燃烧器装上供气管道的整体尺寸，用户需要考虑尺寸 "N" 及 "V" 这两个显示在燃烧器简介及管道简介而按入气压力选配的管道来计算。

Blu 500-1400

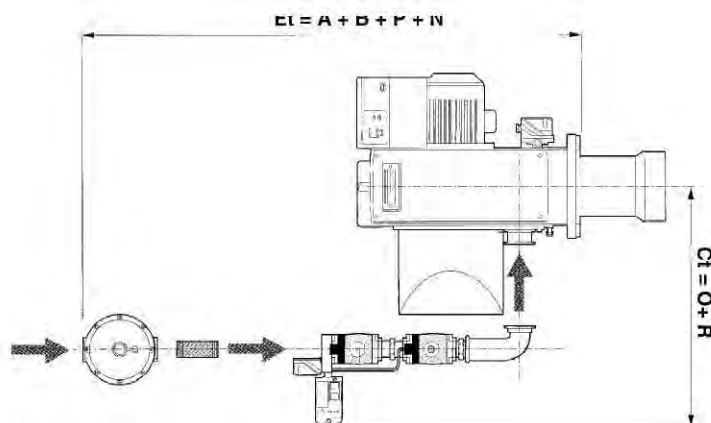

Blu 1700.1-15000.1

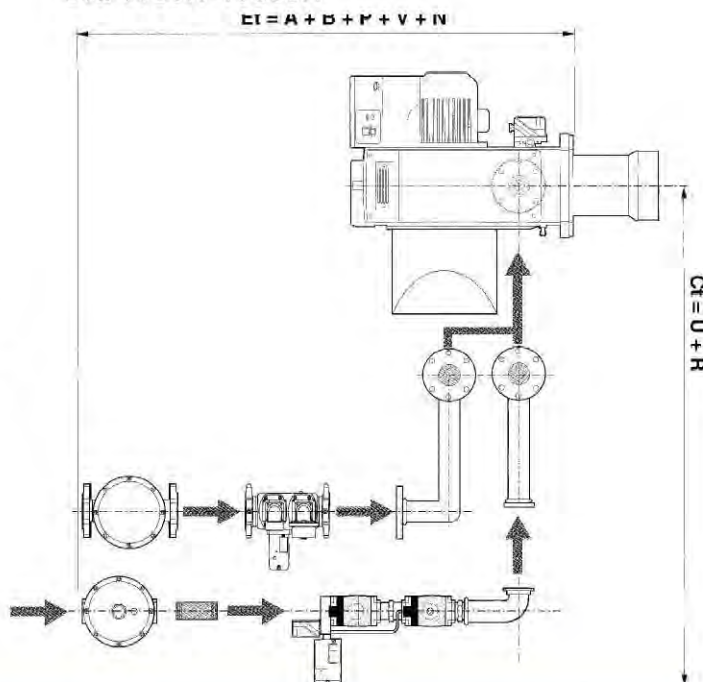

OVERALL DIMENSIONS / 整体尺寸

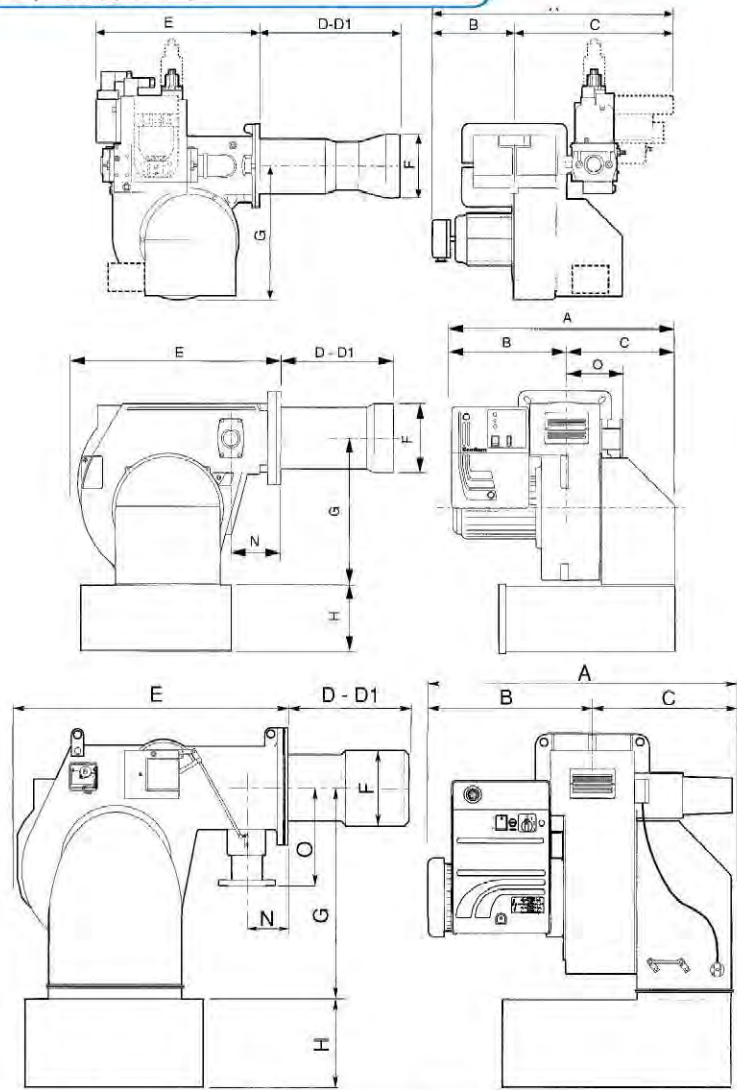

Blu 170 ÷ Blu 250

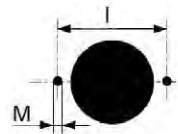

Blu 350 ÷ Blu15000.1

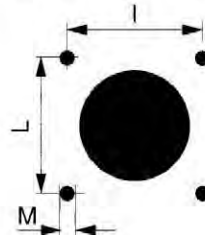

MODELS 型号	A	B	C	D	D1	E	F	G	H	I	L	M	N	O
BLU 170	550	200	350	180	280	360	120	275	-	185	-	M8	-	-
BLU 250	550	200	350	180	280	360	120	275	-	185	-	M8	-	-
BLU 350	520	160	360	200	320	385	138	275	-	190	190	M8	-	-

Dimensions refer to the burner with gas train / 尺寸包括供气管道

MODELS 型号	A	B	C	D	D1	E	F	G	H	I	L	M	N	O
BLU 500	650	330	320	175	395	555	160	385	165*225 •	190	190	M10	115	165
BLU 500.1 LOW NOx	650	330	320	175	395	555	160	385	165*225 •	190	190	M10	115	165
BLU 700	650	330	320	175	395	555	180	385	225 •	190	190	M10	115	165
BLU 700.1 LOW NOx	650	330	320	175	395	555	170	385	225 •	190	190	M10	115	165
BLU 1000	650	330	320	175	395	555	190	385	225 •	190	190	M10	115	165
BLU 1000.1 LOW NOx	650	330	320	175	395	555	190	385	225 •	190	190	M10	115	165
BLU 1200	670	350	320	310	460	555	215	385	225 •	190	190	M10	115	165
BLU 1400	670	350	320	310	460	555	215	385	225 •	190	190	M10	115	165
BLU 1400.1 LOW NOx	670	350	320	310	460	555	200	385	225 •	190	190	M10	115	165
BLU 1700.1 R	710	385	325	340	540	680	200	398	283 •	240	240	M14	125	250
BLU 1700.1	710	385	325	340	540	680	250	398	283 •	240	240	M14	125	250
BLU 2000.1	730	405	325	345	545	680	270	398	283	240	240	M14	125	250
BLU 3000.1	941	448	493	330	530	780	290	466	280	315	315	M16	195	250
BLU 4000.1	941	448	493	365	565	780	320	466	280	315	315	M16	195	250
BLU 5000.1	1019	495	524	375	575	970	320	565	400	330	330	M16	195	250
BLU 6000.1	1069	545	524	375	575	970	320	565	400	330	330	M16	195	250
BLU 7000.1	1210	585	625	470	-	1212	420	800	480	460	460	M20	195	232
BLU 8000.1	1280	655	625	470	-	1212	420	800	480	460	460	M20	195	232
BLU 10000.1	1310	685	625	470	-	1212	420	800	480	460	460	M20	195	232
BLU 12000.1	1420	795	625	470	-	1212	450	800	480	460	460	M20	195	232
BLU 15000.1	1670	800	870	457	-	1750	500	1100	530	620	620	M20	195	255

Dimensions refer to the burner without gas train / 尺寸不包括供气管道

D = short head / 短头 D1 = long head / 长头
 • = silencer optional / 消音器(选购)

* = for Ecomax / 供Ecomax热水锅炉使用
 Dimension (mm) / 尺寸 (mm)

